



GE100-2 2V100AH

GE SERIES-GEL Battery



Specification

Nominal Voltage	2V	
Nominal Capacity(10HR)	100.0AH	
Dimension	Length	170±2mm (6.69 inches)
	Width	72±2mm (2.83 inches)
	Container Height	205±2mm (8.07 inches)
	Total Height (with Terminal)	212±2mm (8.35 inches)
Approx Weight	Approx 5.2 kg (11.46 lbs)	
Terminal	T6	
Container Material	ABS	
Rated Capacity	106.7 AH/5.335A	(20hr, 1.80V/cell, 25°C/77°F)
	100.0 AH/10.00A	(10hr, 1.75V/cell, 25°C/77°F)
	86.0 AH/17.2A	(5hr, 1.75V/cell, 25°C/77°F)
	74.7 AH/24.9A	(3hr, 1.75V/cell, 25°C/77°F)
	58.7 AH/58.7A	(1hr, 1.67V/cell, 25°C/77°F)
Max. Discharge Current	700A (5s)	
Internal Resistance	Approx 1.58mΩ	
Operating Temp. Range	Discharge	-20~55°C (-4 ~ 131°F)
	Charge	0~40°C (32~104°F)
	Storage	-20~50°C (-4 ~ 122°F)
Nominal Operating Temp. Range	25±3°C (77±5°F)	
Cycle Use	Initial Charging Current less than 25.0A. Voltage 2.4V~2.5V at 25°C(77°F)Temp. Coefficient -5mV/°C	
	Standby Use No limit on Initial Charging Current Voltage 2.25V~2.3V at 25°C(77°F)Temp. Coefficient -3mV/°C	
Capacity affected by Temperature	40°C (104°F)	103%
	25°C (77°F)	100%
	0°C (32°F)	86%
Self Discharge	JYC GE series batteries may be stored for up to 9 months at 25°C(77°F) and then a freshening charge is required. For higher temperatures the time interval will be shorter.	

Applications

- ◆ Telecommunications
- ◆ Solar system
- ◆ Wind power system
- ◆ Engine starting
- ◆ Wheelchair
- ◆ Floor cleaning machines
- ◆ Golf trolley
- ◆ Boats

ISO 9001	ISO 14001	OHSAS 18001	TLC
CE	RoHS	UL	PV Battery

Constant Current Discharge (Amperes) at 25 °C (77°F)

F.V/Time	20min	30min	45min	1h	2h	3h	4h	5h	6h	7h	8h	9h	10h	20h
1.85V/cell	87.0	68.4	52.1	45.3	28.9	22.0	18.3	15.8	13.6	12.0	10.9	9.92	9.39	5.12
1.80V/cell	99.9	76.4	57.6	50.0	31.3	23.6	19.4	16.6	14.3	12.6	11.4	10.4	9.81	5.34
1.75V/cell	112.2	84.0	62.1	53.4	33.2	24.9	20.3	17.2	14.8	13.1	11.8	10.8	10.0	5.44
1.70V/cell	120.9	90.0	66.0	56.6	35.2	26.0	20.9	17.7	15.3	13.5	12.1	11.0	10.2	5.52
1.67V/cell	125.7	93.6	68.4	58.7	36.1	26.8	21.5	18.1	15.6	13.7	12.3	11.2	10.4	5.57
1.60V/cell	136.2	100.0	73.5	62.3	37.5	27.9	22.3	18.7	15.9	14.0	12.5	11.4	10.6	5.65

Constant Power Discharge (Watts) at 25 °C (77°F)

F.V/Time	20min	30min	45min	1h	2h	3h	4h	5h	6h	7h	8h	9h	10h	20h
1.85V/cell	165.2	130.8	100.3	87.5	56.0	42.8	35.6	30.9	26.7	23.7	21.5	19.6	18.6	10.1
1.80V/cell	187.2	144.7	109.8	96.1	60.4	45.7	37.6	32.3	28.0	24.7	22.4	20.6	19.4	10.5
1.75V/cell	207.9	157.3	117.4	102.1	63.8	48.2	39.3	33.4	28.9	25.6	23.1	21.2	19.7	10.7
1.70V/cell	221.6	167.4	124.2	107.8	67.3	50.0	40.4	34.4	29.8	26.4	23.7	21.7	20.2	10.9
1.67V/cell	227.8	171.8	127.6	110.9	68.7	51.4	41.3	35.0	30.2	26.7	24.0	22.0	20.4	11.0
1.60V/cell	244.1	182.3	136.3	117.1	71.1	53.2	42.7	35.9	30.9	27.2	24.4	22.4	20.8	11.1

Note The above data are average values, and can be obtained with 3 charge/discharge cycles. These are not minimum values.



GE100-2 2V100AH GE SERIES-GEL Battery

Dimensions

T6 Terminal Unit: mm [inches]

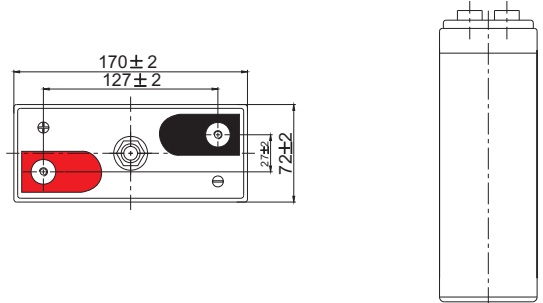
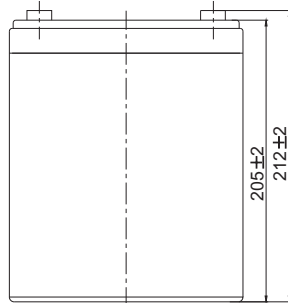
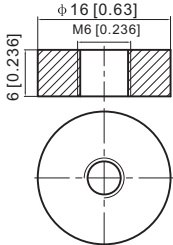

Float Charging Characteristics

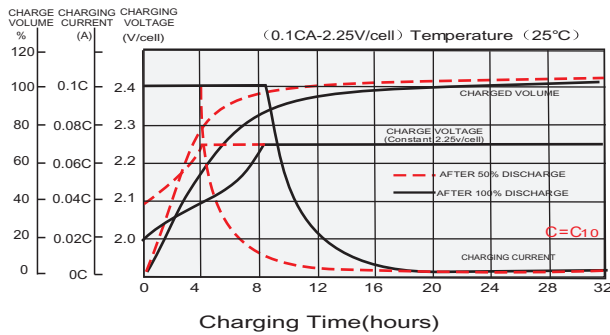

Discharge Characteristics

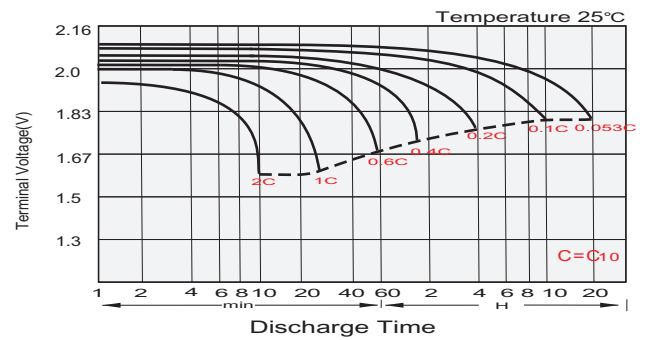

Temperature Effects in Relation to Battery Capacity

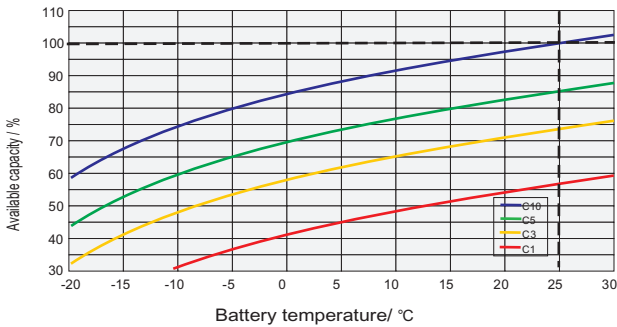

Effect of Temperature on Long Term Float Life

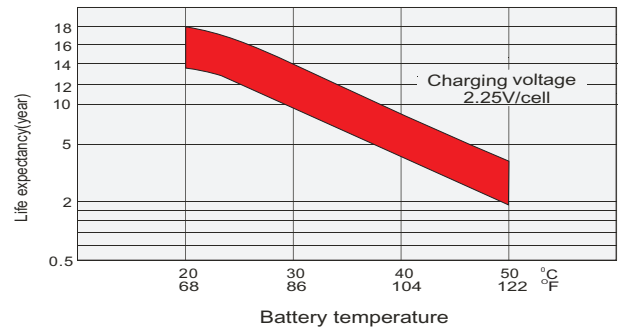

Cycle Life in Relation to Depth of Discharge

Testing condition
Discharging: current 0.17C (FV 1.7V/cell);
Charging: current 0.25C max, voltage 2.45V/cell;
Charging volume: 125% of discharged capacity.

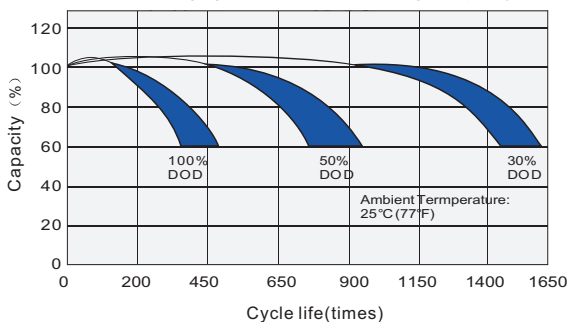

General Relation of Capacity VS. Storage Time

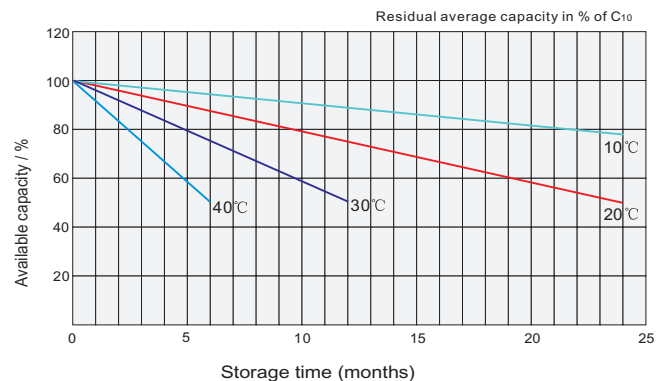

JYC GE BATTERIES

This information is generally descriptive only and is not intended to make or imply any representation, guarantee or warranty with respect to any cells and batteries. Cell and battery designs/specification are subject to modification without notice. Contact JYC for the latest information.